

SPECIAL MENTION 2 | VSOI_2022_T109

Enhancing the Public realm with Community Engagement

Dwarka, a sub - city located in the South - west of Delhi and forms part Zone K. As it is developing area, the aspect of community engagement is low and it makes the urban space unsafe for the users.

Site Context:

The Dwarka Expressway Stretch plays a pivotal role with respect to connectivity. The resident of Dwarka are currently facing lot of difficulty to commute to the office. However the site has many challenges, which have to be addressed to rejuvenate the unused under - bridge spaces for the betterment of public safety.

Concept Note:

The main aim of the design is to engage the community by introducing spaces like Open parks, Workout area, Activity zones, Childer play area, Open Café zone, Open Air Theater for any performance or practice, Pop up stalls to bring in more flexible spaces, Toilet, Reading area for the students. Furthermore, SDG target 16.7 aims to “Ensure responsive, inclusive, participatory and representative decision-making at all levels” and SDG 11 focus on Make cities and human settlements inclusive, safe, resilient and sustainable. By which we are achieving the sustainable development goals.

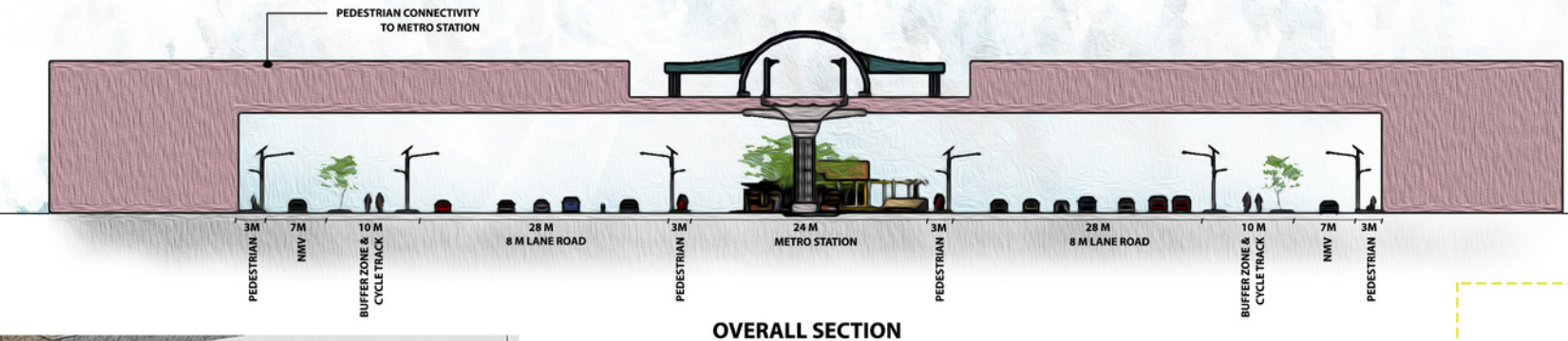

OVERALL SECTION

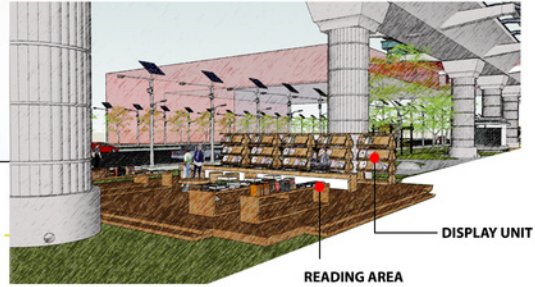

BOOK DISPLAY & STUDY AREA

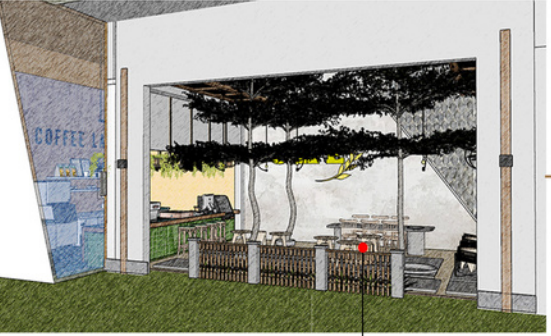

CAFE

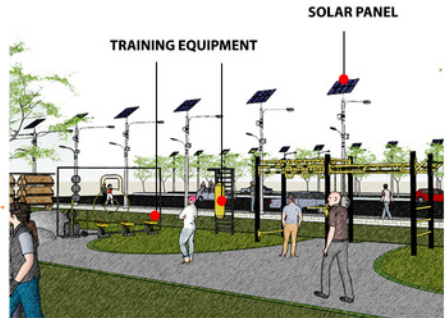
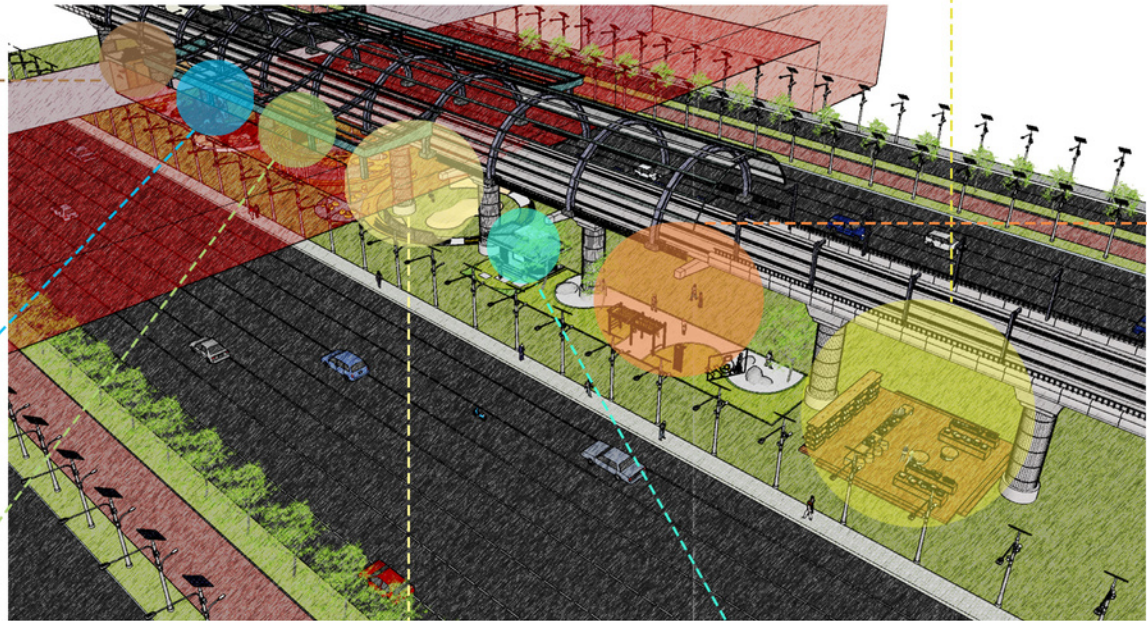

GYM

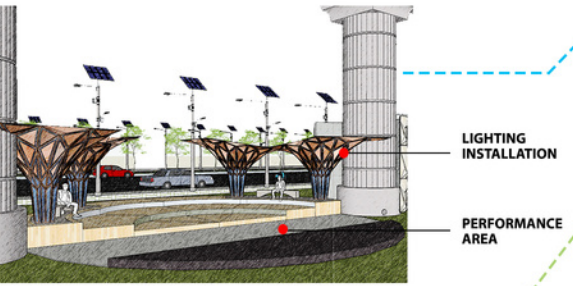

OPEN AIR THEATER

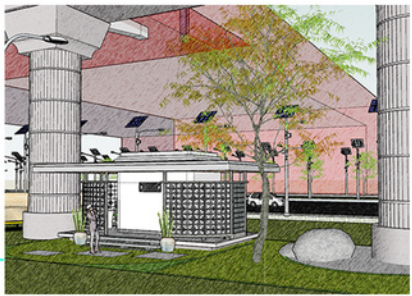

TOILET

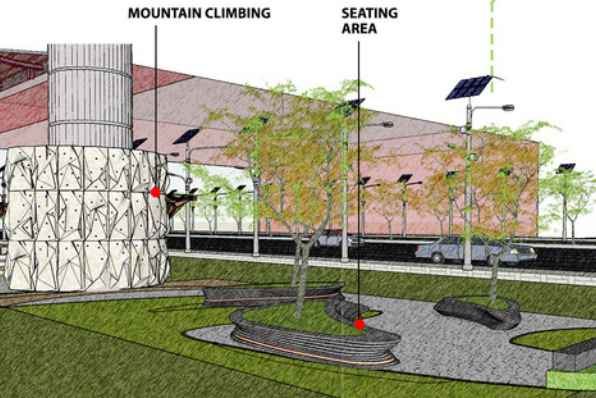

ACTIVITY & SEATING AREA

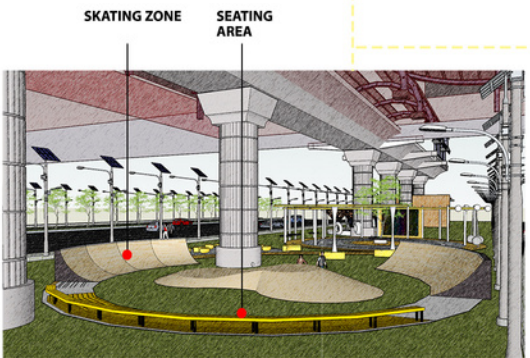

SKATING AREA

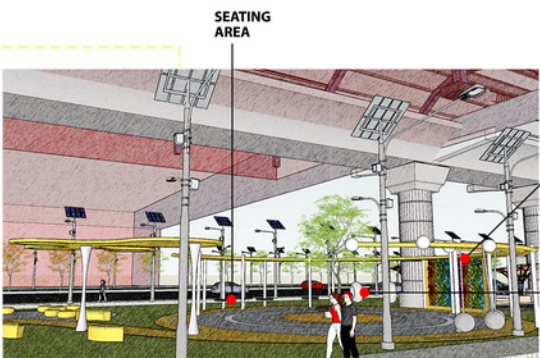

CHILDREN ACTIVITY AREA

